

Overview Plan

01

02

03

04

05

06

07

08

Plan 1 - Sevenoaks Road

Sevenoaks LCWIP Route 1 Otford to Bat and Ball Junction

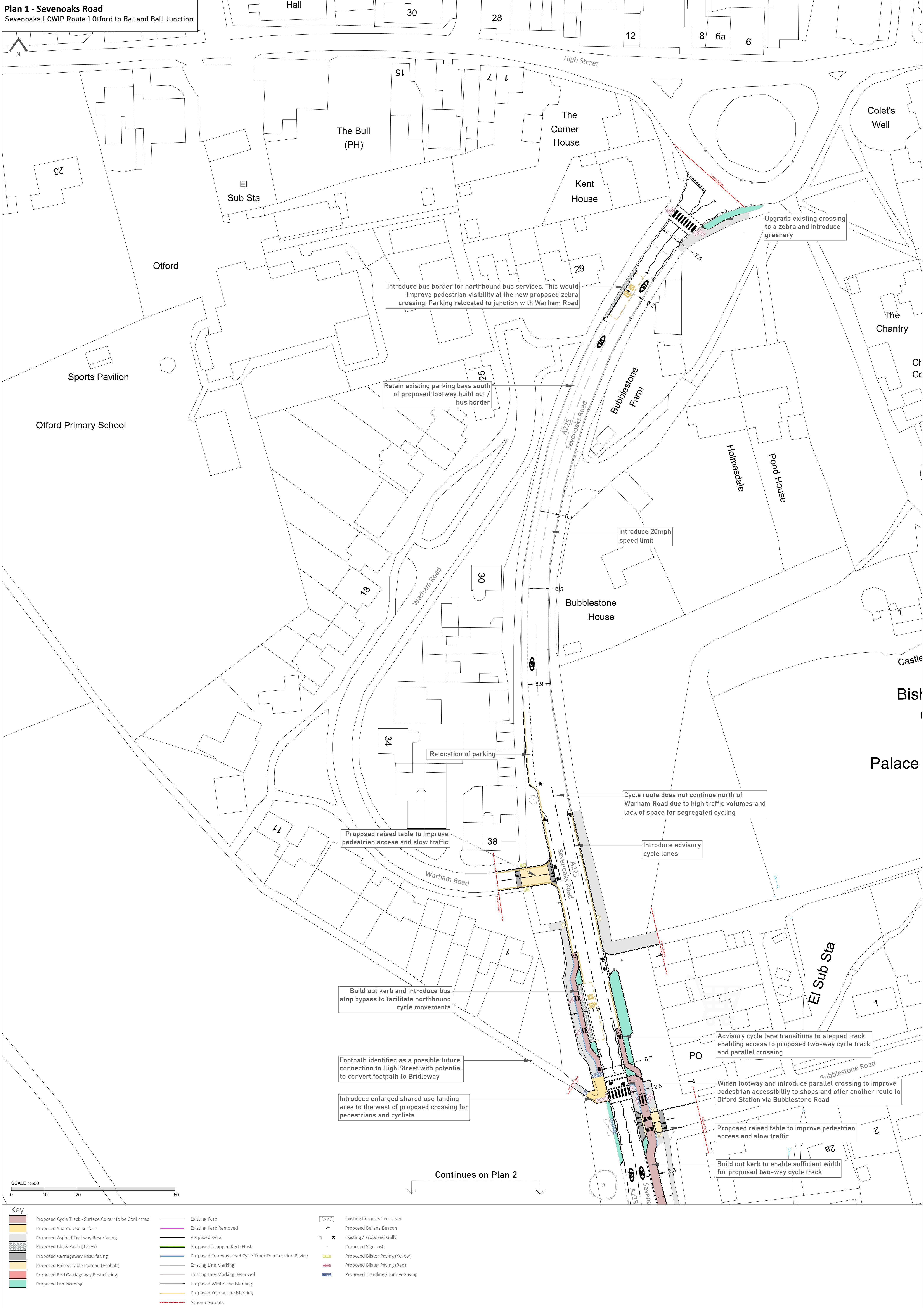

Plan 2 - Sevenoaks Road
Sevenoaks LCWIP Route 1 Otford to Bat and Ball Junction

Continues on Plan 1



Introduce 20mph
speed limit

Cross section 01

Property accesses retained through section

Realign kerb and resurface carriageway at pinch
point over culvert to create space for walking and
cycling on eastern side

Driftwood

Introduce two-way cycle track on eastern section of Sevenoaks
Road

Burway

Cycle track narrows at bus stop bypass to
help reduce speeds of cycles on approach

Silver
Stream

Build out kerb and introduce bus stop bypass
to facilitate two-way cycle movements

Watercroft

Kursella

Rhylock

Willow
House

Meadow
Springs

Troutbrook

Proposed raised table to improve pedestrian
access and slow traffic

Extend 30mph speed limit up
to cemetery.

Trim back verge to enable footway widening

Property accesses retained through section

Continues on Plan 3

Cross Section 01 - Sevenoaks Road A225
Bi-directional cycle track, with bus stop bypass

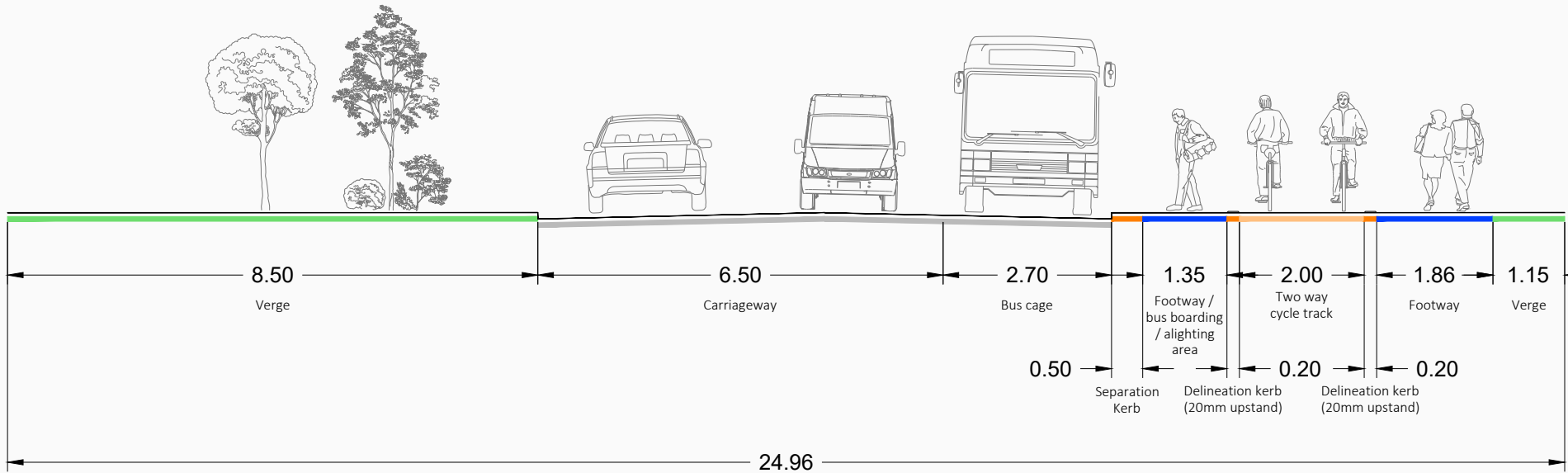

SCALE 1:500
0 10 20 50

<div></div> Proposed Cycle Track - Surface Colour to be Confirmed	<div></div> Existing Kerb	<div></div> Existing Property Crossover
<div></div> Proposed Shared Use Surface	<div></div> Existing Kerb Removed	<div></div> Proposed Belisha Beacon
<div></div> Proposed Asphalt Footway Resurfacing	<div></div> Proposed Kerb	<div></div> Existing / Proposed Gully
<div></div> Proposed Block Paving (Grey)	<div></div> Proposed Dropped Kerb Flush	<div></div> Proposed Signpost
<div></div> Proposed Carriageway Resurfacing	<div></div> Proposed Footway Level Cycle Track Demarcation Paving	<div></div> Proposed Blister Paving (Yellow)
<div></div> Proposed Raised Table Plateau (Asphalt)	<div></div> Existing Line Marking	<div></div> Proposed Blister Paving (Red)
<div></div> Proposed Red Carriageway Resurfacing	<div></div> Existing Line Marking Removed	<div></div> Proposed Tramline / Ladder Paving
<div></div> Proposed Landscaping	<div></div> Proposed White Line Marking	
	<div></div> Proposed Yellow Line Marking	
	<div></div> Scheme Extents	

Plan 3 - Sevenoaks Road / Otford Road
Sevenoaks LCWIP Route 1 Otford to Bat and Ball Junction

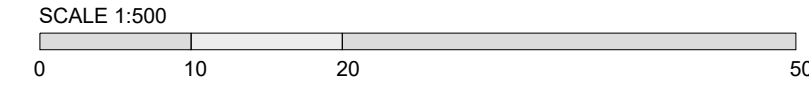
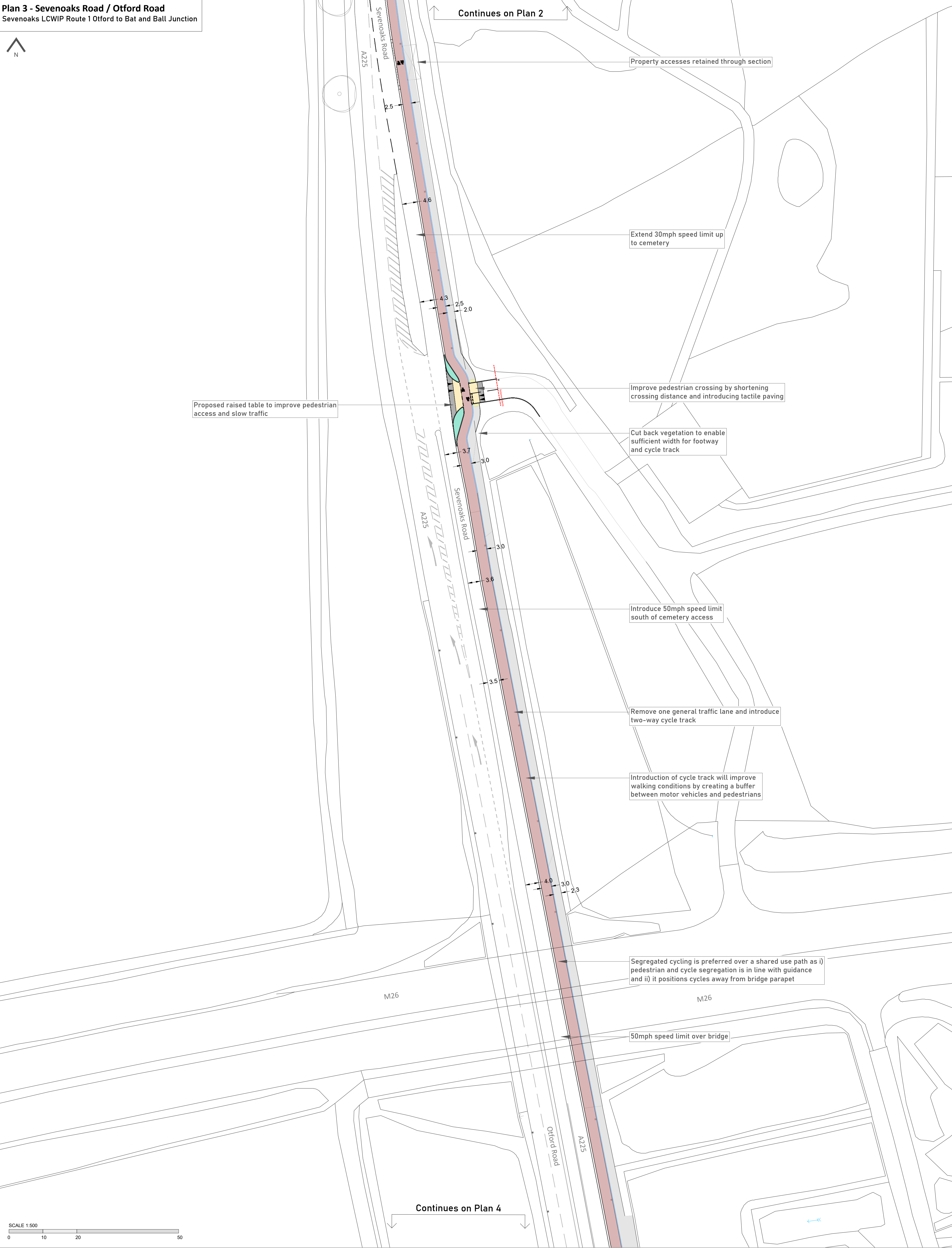

	Proposed Cycle Track - Surface Colour to be Confirmed		Existing Kerb		Existing Property Crossover
	Proposed Shared Use Surface		Existing Kerb Removed		Proposed Belisha Beacon
	Proposed Asphalt Footway Resurfacing		Proposed Kerb		Existing / Proposed Gully
	Proposed Block Paving (Grey)		Proposed Dropped Kerb Flush		Proposed Signpost
	Proposed Carriageway Resurfacing		Proposed Footway Level Cycle Track Demarcation Paving		Proposed Blister Paving (Yellow)
	Proposed Raised Table Plateau (Asphalt)		Existing Line Marking		Proposed Blister Paving (Red)
	Proposed Red Carriageway Resurfacing		Existing Line Marking Removed		Proposed Tramline / Ladder Paving
	Proposed Landscaping		Proposed White Line Marking		
			Proposed Yellow Line Marking		
			Scheme Extents		

Plan 4 - Otford Road
Sevenoaks LCWIP Route 1 Otford to Bat and Ball Junction

Continues on Plan 3

Introduce 50mph speed limit

Remove one general traffic lane and introduce two-way cycle track

Introduction of cycle track will improve walking conditions by creating a buffer between motor vehicles and pedestrians

Segregated cycling is preferred over a shared use path as i) pedestrian and cycle segregation is in line with guidance and ii) it positions cycles away from bridge

Cross section 02

Cross Section 02 - Sevenoaks Road A225
Bi-directional cycle track, with bus stop bypass

SCALE 1:500

Continues on Plan 5

Key

Proposed Cycle Track - Surface Colour to be Confirmed	Existing Kerb	Existing Property Crossover
Proposed Shared Use Surface	Existing Kerb Removed	Proposed Belisha Beacon
Proposed Asphalt Footway Resurfacing	Proposed Kerb	Existing / Proposed Gully
Proposed Block Paving (Grey)	Proposed Dropped Kerb Flush	Proposed Signpost
Proposed Carriageway Resurfacing	Proposed Footway Level Cycle Track Demarcation Paving	Proposed Blister Paving (Yellow)
Proposed Raised Table Plateau (Asphalt)	Existing Line Marking	Proposed Blister Paving (Red)
Proposed Red Carriageway Resurfacing	Existing Line Marking Removed	Proposed Tramline / Ladder Paving
Proposed Landscaping	Proposed White Line Marking	
	Proposed Yellow Line Marking	
	Scheme Extents	

Plan 5 - Sevenoaks Road
Sevenoaks LCWIP Route 1 Otford to Bat and Ball Junction

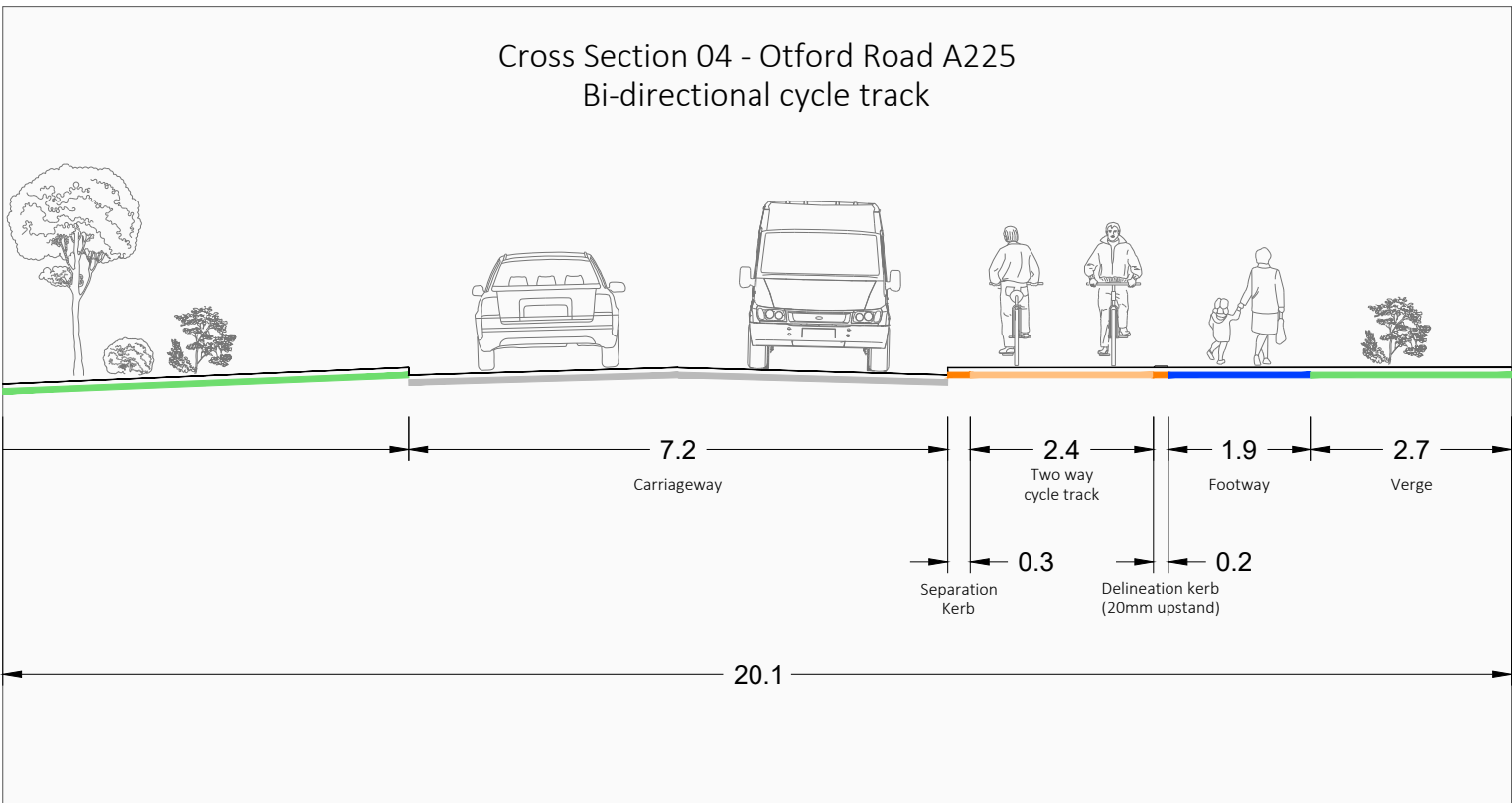
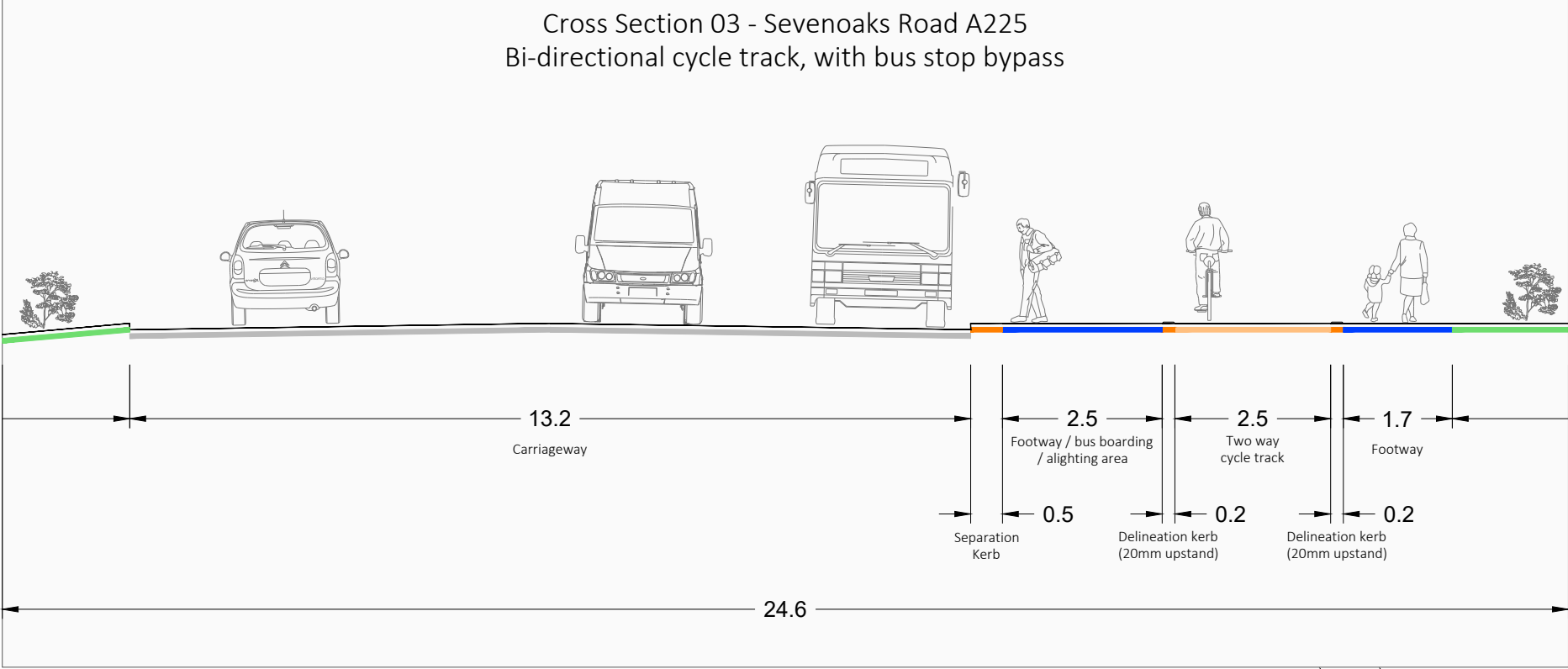
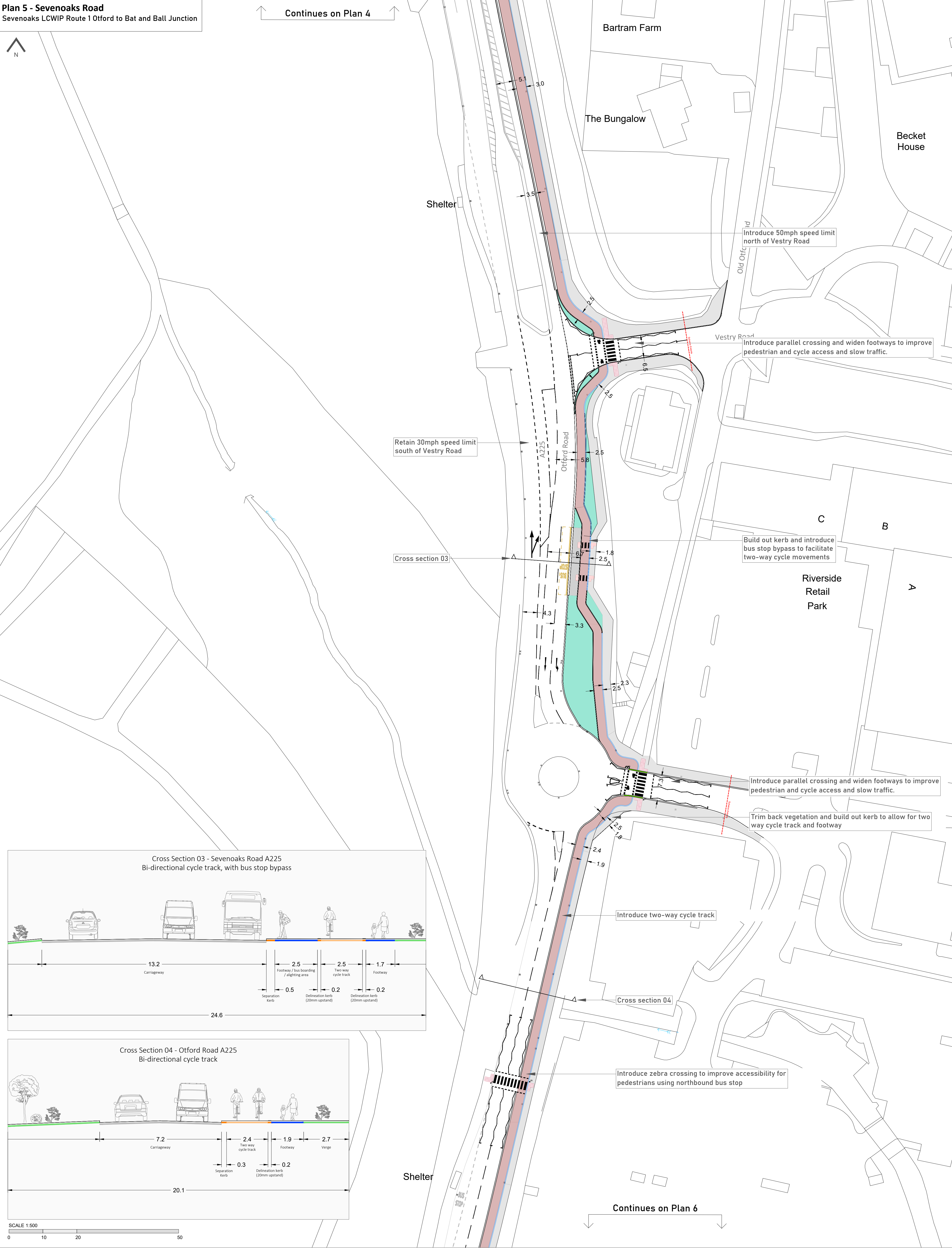

SCALE 1:500

0 10 20 50



Continues on Plan 5

Shelter

Introduce two-way cycle track

Upgrade existing bus stop flag to shared use bus border to incorporate cycle track (Sainsbury's)

Introduce Toucan crossing for pedestrians and cyclists. Proposed crossing will improve access to shops for pedestrians and cyclists

Cycle track splits at junction to facilitate northbound and southbound cycle movements

Proposed raised table to improve pedestrian access and slow traffic

Proposed raised table to improve pedestrian access and slow traffic

Introduce 20mph speed limit

Introduce speed humps at 100m intervals along Crampton's Road to reduce traffic speeds

Introduce cycle symbols in along Crampton's Road to assist cyclists with wayfinding

Cross section 05

Continues on Plan 7

Council Depot

Jubilee Cottages

A225 Otford Road

Crampton's Road

El Sub Sta

Cress Court

ESS

Moor Cottage

The Moor Road

Cross Section 05 - Crampton's Road
On carriageway cycling

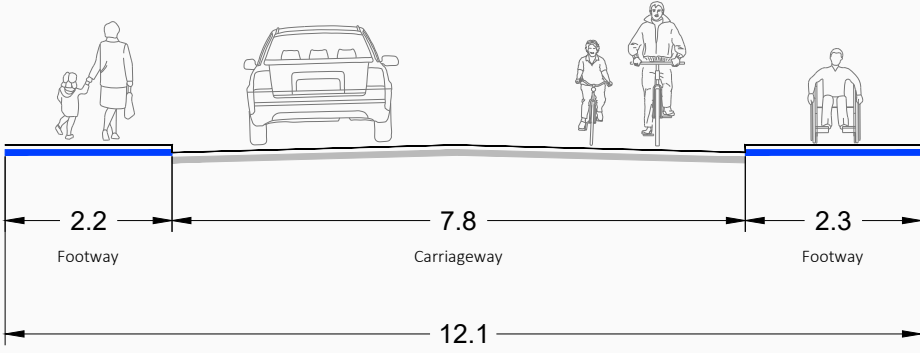

SCALE 1:500

	Proposed Cycle Track - Surface Colour to be Confirmed		Existing Kerb		Existing Property Crossover
	Proposed Shared Use Surface		Existing Kerb Removed		Proposed Belisha Beacon
	Proposed Asphalt Footway Resurfacing		Proposed Kerb		Existing / Proposed Gully
	Proposed Block Paving (Grey)		Proposed Dropped Kerb Flush		Proposed Signpost
	Proposed Carriageway Resurfacing		Proposed Footway Level Cycle Track Demarcation Paving		Proposed Blister Paving (Yellow)
	Proposed Raised Table Plateau (Asphalt)		Existing Line Marking		Proposed Blister Paving (Red)
	Proposed Red Carriageway Resurfacing		Existing Line Marking Removed		Proposed Tramline / Ladder Paving
	Proposed Landscaping		Proposed White Line Marking		
			Proposed Yellow Line Marking		
			Scheme Extents		

Plan 7 - Crampton's Road
Sevenoaks LCWIP Route 1 Otford to Bat and Ball Junction



SCALE 1:500
0 10 20 50

	Proposed Cycle Track - Surface Colour to be Confirmed		Existing Kerb		Existing Property Crossover
	Proposed Shared Use Surface		Existing Kerb Removed		Proposed Belisha Beacon
	Proposed Asphalt Footway Resurfacing		Proposed Kerb		Existing / Proposed Gully
	Proposed Block Paving (Grey)		Proposed Dropped Kerb Flush		Proposed Signpost
	Proposed Carriageway Resurfacing		Proposed Footway Level Cycle Track Demarcation Paving		Proposed Blister Paving (Yellow)
	Proposed Raised Table Plateau (Asphalt)		Existing Line Marking		Proposed Blister Paving (Red)
	Proposed Red Carriageway Resurfacing		Existing Line Marking Removed		Proposed Tramline / Ladder Paving
	Proposed Landscaping		Proposed White Line Marking		
			Proposed Yellow Line Marking		
			Scheme Extents		

Plan 8 - Crampton's Road / Otford Road
Sevenoaks LCWIP Route 1 Otford to Bat and Ball Junction

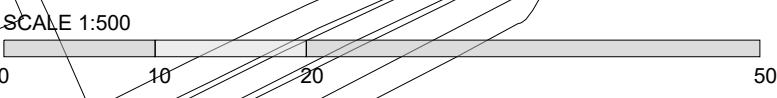
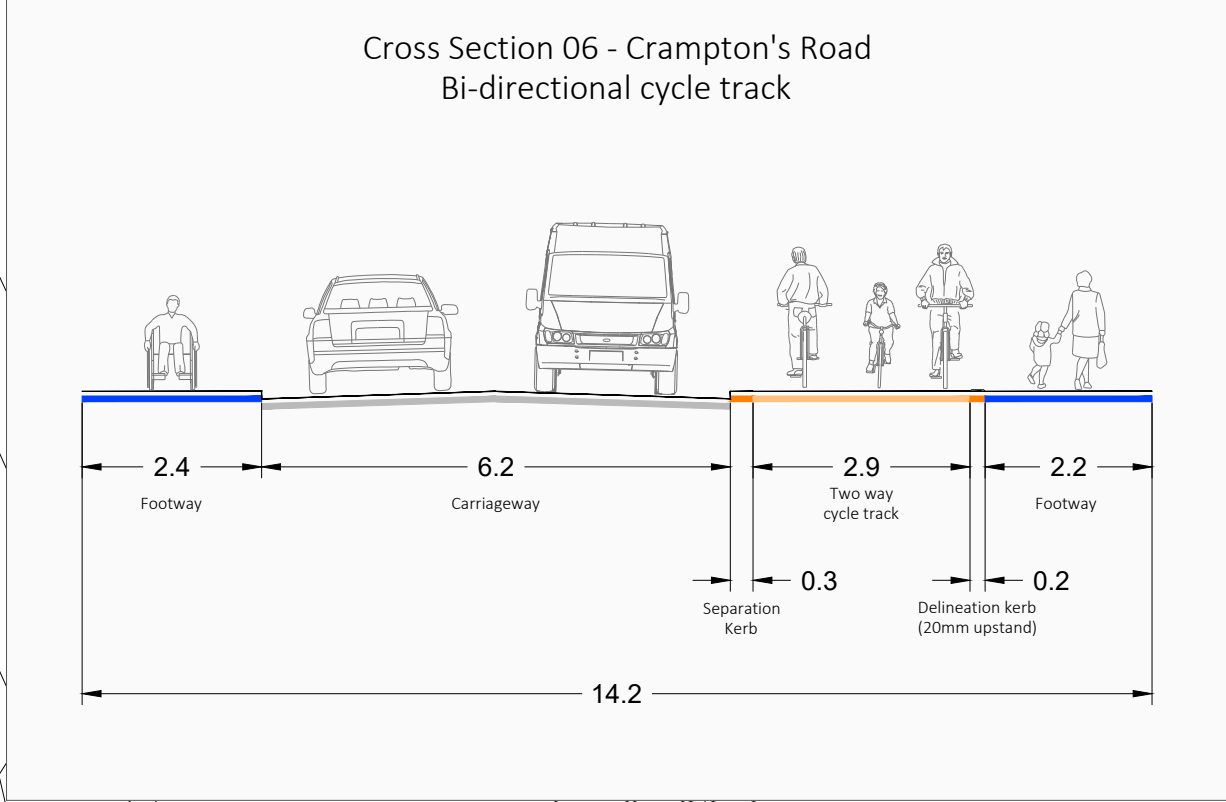
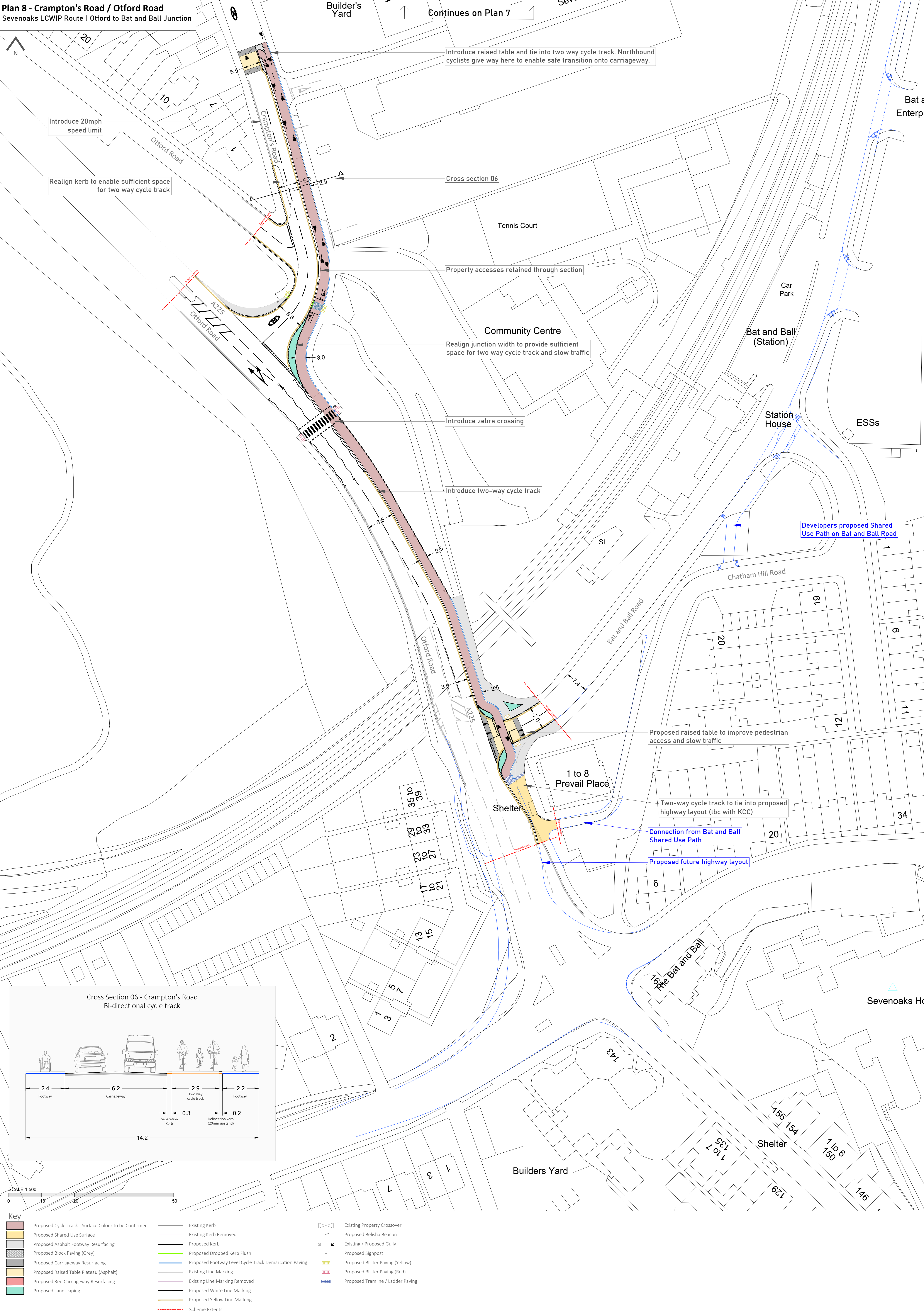

- | | | |
|---|---|---|
| <div></div> Proposed Cycle Track - Surface Colour to be Confirmed | <div></div> Existing Kerb | <div></div> Existing Property Crossover |
| <div></div> Proposed Shared Use Surface | <div></div> Existing Kerb Removed | <div></div> Proposed Belisha Beacon |
| <div></div> Proposed Asphalt Footway Resurfacing | <div></div> Proposed Kerb | <div></div> Existing / Proposed Gully |
| <div></div> Proposed Block Paving (Grey) | <div></div> Proposed Dropped Kerb Flush | <div></div> Proposed Signpost |
| <div></div> Proposed Carriageway Resurfacing | <div></div> Proposed Footway Level Cycle Track Demarcation Paving | <div></div> Proposed Blister Paving (Yellow) |
| <div></div> Proposed Raised Table Plateau (Asphalt) | <div></div> Existing Line Marking | <div></div> Proposed Blister Paving (Red) |
| <div></div> Proposed Red Carriageway Resurfacing | <div></div> Existing Line Marking Removed | <div></div> Proposed Tramline / Ladder Paving |
| <div></div> Proposed Landscaping | <div></div> Proposed White Line Marking | |
| | <div></div> Proposed Yellow Line Marking | |
| | <div></div> Scheme Extents | |